

21A3806

DCM

LOUDSPEAKERS

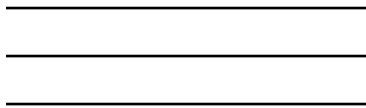

FIRST
CLASS
STAMP
HERE



DCM
7676 S. 46th Street
PHOENIX AZ 85040-6400

W625 / W825
OWNERS MANUAL



CONGRATULATIONS

We appreciate your choice of DCM In-Wall Loudspeakers. Properly installed and operated, DCM In-Wall Loudspeakers should provide years of worry-free listening pleasure. It's important that you follow each step in this guide carefully to insure proper installation. If you have any questions regarding DCM In-Wall Loudspeakers, please call us at 1-877-DCM-LOUD.

SPECIFICATIONS	W625	W825
Frequency Response	48Hz-20kHz +/- 3dB	36Hz-20kHz +/- 3dB
Impedance	8 Ohms	8 Ohms
Power Handling	55 Watts RMS 110 Watts Total	60 Watts RMS 120 Watts Total
Sensitivity (1W/1m)	85dB	86dB
Woofers Diameter	6-1/2"	8"
Tweeter	25mm Soft Dome	25mm Soft Dome
Mounting Depth	2-7/8"	3-1/4"
Crossover Frequency	4kHz	3kHz
Baffle Size (H x W)	12" x 8-9/16"	14" x 10"

PAINTING YOUR DCM IN-WALL

DCM In-Wall speakers are designed to accept all types of interior and exterior paints. Spray or roller application should provide excellent results. A paint shield is included with all DCM In-Wall speakers to protect the speakers during the painting process.

TEN YEAR LIMITED WARRANTY

DCM In-Wall Loudspeakers are guaranteed against defects in parts and workmanship for a period of ten (10) years from the date of purchase. Speakers found defective during that period will be repaired by DCM without charge for parts. This warranty extends to the original purchaser from an authorized DCM retailer only.

This warranty does not extend to equipment damage due to negligence, misuse, improper installation, shipping damage, abuse or accident. This warranty is void if it is determined that unauthorized parties have attempted repairs or alterations of any nature.

Defective parts will be repaired, adjusted or replaced with no charge for materials or labor if the purchaser returns the speaker together with the original sales receipt or other proof of purchase at the purchaser's expense to DCM, 282 Carver Street, Winslow, IL. 61089. No implied warranties shall extend beyond ten years from the original date of purchase. Incidental and consequential damages are expressly excluded from this warranty and may not be recovered by a purchaser as a result of breach of any warranty.

The attached warranty card must be filled out and mailed within 10 days of purchase to validate warranty. Retain the top portion for your records. Specifications subject to change without notice.

(This registration must be filled out and mailed within 10 days of purchase to validate warranty.)

WARRANTY REGISTRATION

MODEL# _____

NAME _____

STREET _____

CITY _____ STATE _____ ZIP _____

DATE PURCHASED _____

PLACE PURCHASED _____

Purchased as a: Packaged System () Replacement System ()
 Speakers Only () Extension Speakers ()

If replacement, what is the name and model number of the system replaced?
 Name _____ Model# _____

What other Brands did you consider? _____

Why did you purchase DCM speakers?
 Sound () Price () Dealer Recommendation () Other ()

Comments _____

Other Products From DCM

In-Ceiling Loudspeakers

C520

5-1/4" Coaxial In-Ceiling Speaker w/
swivel tweeter

Impedance: 8 ohms

Sensitivity: 85dB

50 Watts RMS/100 Watts Total

Frequency Response: 60Hz-20kHz

7-3/4"Dia. x 3-3/4"D

C825

8" Coaxial In-Ceiling Speaker w/
swivel tweeter

Impedance: 8 ohms

Sensitivity: 85dB

60 Watts RMS/120 Watts Total

Frequency Response: 40Hz-20kHz

10-3/4"Dia. x 4"D

C625

6-1/2" Coaxial In-Ceiling Speaker w/
swivel tweeter

Impedance: 8 ohms

Sensitivity: 85dB

55 Watts RMS/110 Watts Total

Frequency Response: 50Hz-20kHz

9"Dia. x 3-1/2"D

Home Loudspeakers

DCM6

6-1/2" Two-Way Home Loudspeaker

Impedance: 8 ohms nominal

Sensitivity: 89dB

75 Watts RMS/150 Watts Total

Frequency Response: 58Hz-20kHz

12.992"H x 7.992"W x 7.795"D

DCM10

10" Two-Way Home Loudspeaker

Impedance: 8 ohms nominal

Sensitivity: 94dB

200 Watts RMS/400 Watts Total

Frequency Response: 35Hz-20kHz

31.312"H x 15.825"W x 12.501"D

DCM6C

6-1/2" Center Channel Loudspeaker

Impedance: 8 ohms nominal

Sensitivity: 89dB

75 Watts RMS/150 Watts Total

Frequency Response: 58Hz-20kHz

7.992"H x 19.685"W x 7.204"D

DCM12

12" Two-Way Home Loudspeaker

Impedance: 8 ohms nominal

Sensitivity: 97dB

250 Watts RMS/500 Watts Total

Frequency Response: 30Hz-20kHz

33.312"H x 17.638"W x 15.938"D

LOUDSPEAKER PLACEMENT

DCM In-Wall Loudspeakers are designed to work within any interior decorating scheme. They can be installed in virtually any location where flush mounting is possible. To maximize their sound performance however certain guidelines should be followed. For the best stereo reproduction the two loudspeakers should be placed an equal distance from your listening position and separated so that the angle between them, at the listening position, is between 40 and 60 degrees.

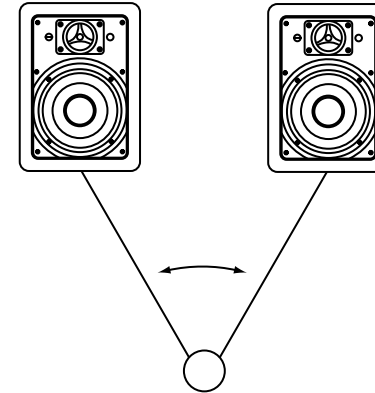

For best stereo imaging, we recommend that the units be placed so that the tweeters are as close as possible to the ear level of a seated listener. As this is not always possible in keeping with aesthetic design of a particular room, MODEL W625 and W825 In-Wall Loudspeakers were designed with a pivoting tweeter which rotates to allow you to "aim" the high frequencies toward the listening position.

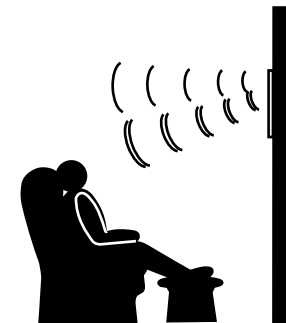

(Normal Dispersion

(Dispersion After Tweeter Adjustment

TWEETER LEVEL ADJUSTMENT

The output of the tweeter can be adjusted to compensate for speaker placement/listening positions that are less than ideal. The 0dB position is designed to provide the smoothest frequency response on axis. If the high frequency response is considered to be too strong or too weak, the tweeter level can be increased (+3dB position) or decreased (-3dB position) to suit the listener's preference.

STEP 1

Using a stud finder (available at low cost at most hardware stores) or other accurate method, locate center point between two studs and mark. Using template provided, trace hole pattern on surface of wall. Placing a bubble level on either the horizontal or vertical guidelines of template will assist you in leveling the hole pattern.

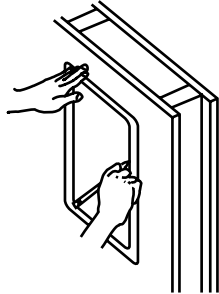

STEP 2

Using a sabre saw, keyhole saw or very sharp utility knife, cut hole in wall, following traced pattern.

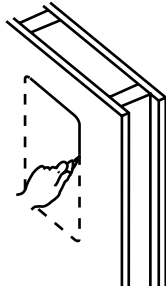

STEP 3

Run loudspeaker wires to sound source location. There are several methods you can use to accomplish wiring, depending on the construction characteristics of the room or house. You can add a professional touch to your installation by using a speaker terminal plate at the source location. Leave sufficient amount of wire at speaker location (8 to 10 inches) to complete connection.

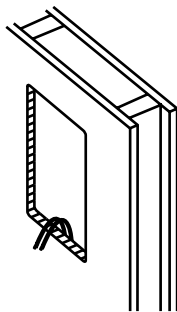

STEP 4

Attach loudspeaker wires to speaker terminals, observing correct polarity (positive to positive and negative to negative), and position speaker frame into cutout as shown. Be careful not to pinch wires in the process.

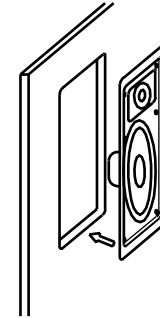

STEP 5

Carefully tighten the six mounting screws. This will cause the mounting wings to rotate out behind the mounting surface and secure the speaker in place.

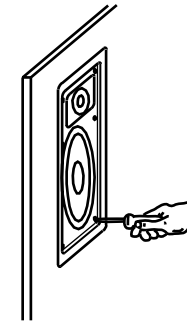

STEP 6

After the speaker panel is secured tightly, test for sound. When you are satisfied the speaker is operational, affix grill. As grill is designed for a snug fit, you'll need to position one edge into slot first, and press or squeeze around perimeter of grill, while pushing leading edges into grill slot.

